

# MECHANICAL ASSEMBLY FOR RU FLEX 2100 HLS FLOAT POSITIONING APPARATUS

---

**PERSONAL PROTECTIVE EQUIPMENT (PPE) REQUIRED:**

- Item
- All standard Electrolab PPE

<b><u>PARTS REQUIRED</u></b>	<b><u>TOOLS REQUIRED</u></b>
<ul style="list-style-type: none"> <li>• (1 ea.) EL 55180 – 2100 Flex Hose Top Housing HLS</li> <li>• (1 ea.) EL 55181 – 2100 Flex Top Housing Insert</li> <li>• (1 ea.) EL 55182 – 2100 Flex HLS Float Ring</li> <li>• (2 ea.) EL 55183 – 2100 Flex HLS FG Rod Stop</li> <li>• (2 ea.) 2100 Flex HLS FG Rod               <ul style="list-style-type: none"> <li>○ EL 55184 – 6” Rod</li> <li>○ EL 55185 – 8” Rod</li> <li>○ EL 55186 – 10” Rod</li> </ul> </li> <li>• (4 ea.) EL 19185 – Flat Head Screw</li> <li>• (2 ea.) EL 19186 – Set Screw</li> <li>• (2 ea.) EL 19187 – Nail Screw</li> <li>• (6 ea.) EL 19188 – Square Nut</li> <li>• (1 ea.) EL 23120 – Red Loctite</li> </ul>	<ul style="list-style-type: none"> <li>• Pliers</li> <li>• Allen Key Set</li> </ul>

# MECHANICAL ASSEMBLY FOR RU FLEX 2100 HLS

## FLOAT POSITIONING APPARATUS

---

### PROCEDURE

*Always follow required safety protocol when performing a procedure.*

1. Insert both *fiberglass rods* (see table) into the *HLS float ring* (EL 55182) and align holes. Use a pair of pliers to press two *nail screws* (EL 19187) into the HLS ring. **NOTE:** The holes closest to the end of the fiberglass rod will go into the HLS ring.

HLS Flt Kit-UFX	EL
15' - 24'	55184 – 2100 Flex Hose_Fiberglass Rod 6"
25' - 34'	55185 – 2100 Flex Hose_Fiberglass Rod 8"
35' - 44'	55186 – 2100 Flex Hose_Fiberglass Rod 10"

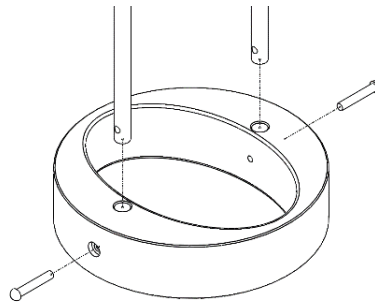

FIGURE 1

2. Install the *top housing insert* (EL 55181) onto the fiberglass rods as shown in Figure 2.

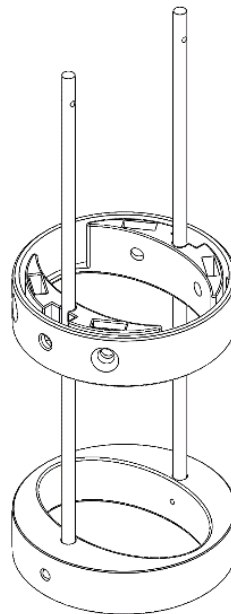

FIGURE 2

## MECHANICAL ASSEMBLY FOR RU FLEX 2100 HLS

### FLOAT POSITIONING APPARATUS

3. Install both *fiberglass rod stops* (EL 55183) onto the fiberglass rods from Step 1 by pressing the existing screw nails through the upper holes of the fiber glass rods.

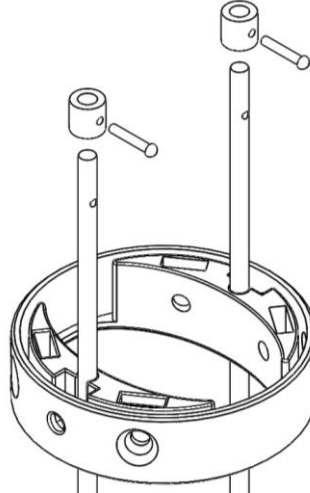

FIGURE 3

4. Pull the top housing insert from Step 2 to its upper limit. Insert six square nuts (EL 19188) into each of its cavities. **NOTE:** Square nuts will drop into place. They will fall out if the assembly is held upside down.

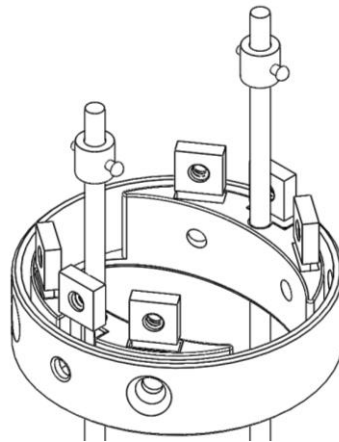

FIGURE 4

## MECHANICAL ASSEMBLY FOR RU FLEX 2100 HLS

### FLOAT POSITIONING APPARATUS

5. Insert the *HLS top housing* (EL 55180) into the top housing insert and align holes.

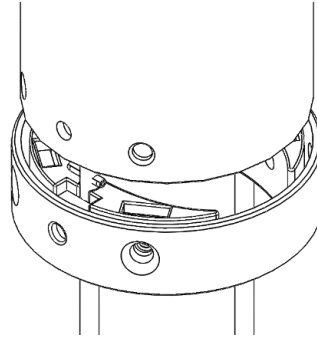

FIGURE 5

6. Apply Loctite to the threads of four *flat head screws* (EL 19185) and insert screws through the top housing. Thread screws into the insert as shown in Figure 6.

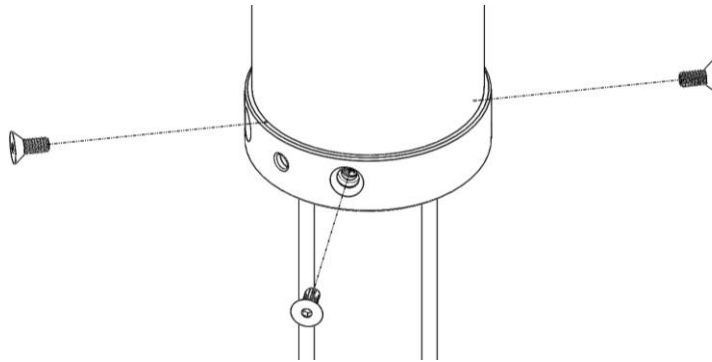

FIGURE 6

7. Install two set screws (EL 19186) until they make contact with the fiberglass rod. Once contact is achieved, back out the set screw for  $\frac{1}{2}$  of a turn.

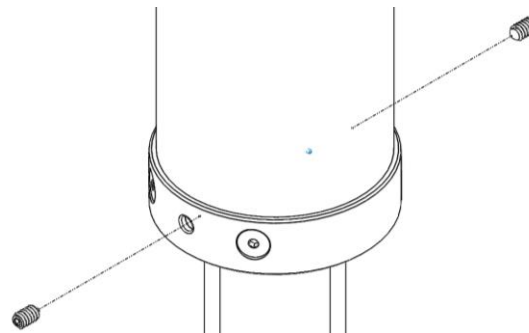

FIGURE 7

## MECHANICAL ASSEMBLY FOR RU FLEX 2100 HLS FLOAT POSITIONING APPARATUS

---

8. Fully retract the HLS ring toward the top housing.

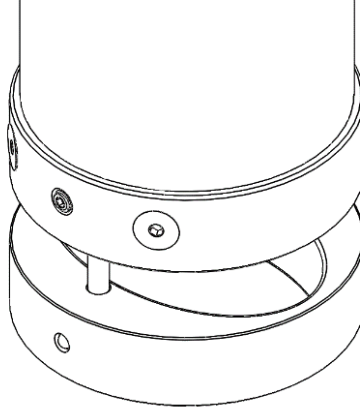

FIGURE 8

9. Assembly complete.

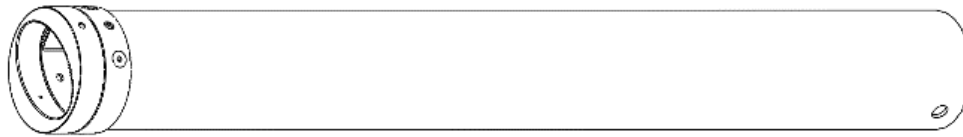

FIGURE 9